



6212 NR Deep groove ball bearings

- SKF Explorer

Deep groove ball bearings

Bearing data

[Tolerances](#),

Normal (metric), P6, P5, Normal (inch),

[Radial internal clearance](#),

Matched bearing pairs, Stainless steel
d < 10 mm, Other bearings

Bearing interfaces

[Seat tolerances for standard conditions](#),

[Tolerances and resultant fits](#)

Technical specification

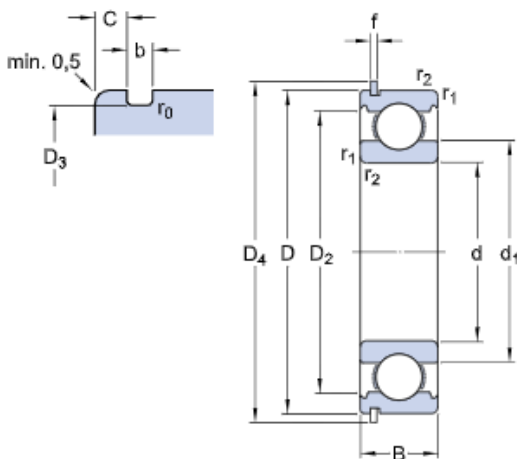

DIMENSIONS

d	60 mm	Bore diameter
D	110 mm	Outside diameter
B	22 mm	Width
d ₁	≈ 75.5 mm	Shoulder diameter
D ₂	≈ 98 mm	Recess diameter
D ₃	106.81 mm	Diameter of snap ring groove
D ₄	116.6 mm	Outside diameter of snap ring
b	2.7 mm	Width of snap ring groove
C	3.28 mm	Distance outer ring from side face to snap ring groove
f	2.46 mm	Width of snap ring
r ₀	max. 0.6 mm	Bottom radius of snap ring groove
r _{1,2}	min. 1.5 mm	Chamfer dimension

ABUTMENT DIMENSIONS

d _a	min. 69 mm	Diameter of shaft abutment
D _a	max. 101 mm	Diameter of housing abutment
D _b	min. 118 mm	Diameter of snap ring recess in the housing

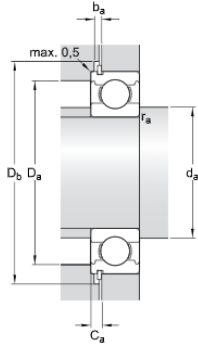

b_a	min. 3 mm	Width of snap ring recess in the housing
c_a	max. 5.74 mm	Distance from outer ring side face to snap ring back face
r_a	max. 1.5 mm	Radius of shaft or housing fillet

CALCULATION DATA

C	55.3 kN	Basic dynamic load rating
C_0	36 kN	Basic static load rating
P_u	1.53 kN	Fatigue load limit
	13 000 r/min	Reference speed
	8 000 r/min	Limiting speed
k_r	0.025	Minimum load factor
f_0	14.3	Calculation factor

MASS

	0.8 kg	Mass bearing
--	--------	--------------

INCLUDED PRODUCTS

SP 110	Snap ring
--------	-----------

TOLERANCE CLASS

P6	Dimensional tolerances
P6	Radial run-out